

# Ampas

last update 24/09/2015

BEL1088



**BEL LIGHTING**

BEL LIGHTING srl  
Avenue Ernest Solvay 42  
B-1480 Saintes (Tubize)  
Belgium  
Phone: +32(0)2 3552428  
Fax: +32(0)2 3550396  
e-mail: info@bel-lighting.com  
www.bel-lighting.com

## INSTALLATION INSTRUCTIONS - PART A

1. FIT THE WALL FIXATION ON THE WALL
2. MAKE THE ELECTRICAL CONNECTION
3. PLACE THE LUMINARY
4. SWITCH ON

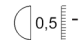
code 8015.G9.04

max.2 x 25W H-PIN/G9 - 230V~ - CE - IP65 -  -  - 

code 8015.W80.04

6W - 230V~ - CE - IP65 -  -  - 

### 1 DIMENSIONS HOLES

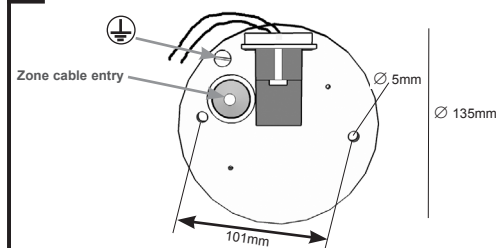

**IMPORTANT : Gland for cable  $\varnothing 1 \rightarrow 9\text{mm}$**

### 2 ELECTRICAL CONNECTION

- NL - Voeg de voedingskabel in de beschermingskoker (A)  
FR - Insérer le câble d'alimentation dans la gaine de protection(A).  
EN - Insert the feeder in the protection sheath (A)  
DE - Das Kabel in die Schutzhülle einfügen (A)  
ΕΛ - Παρεμβάλετε τον τροφοδοτη στη θηκη προστασιας(A)

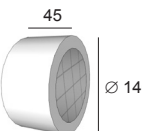
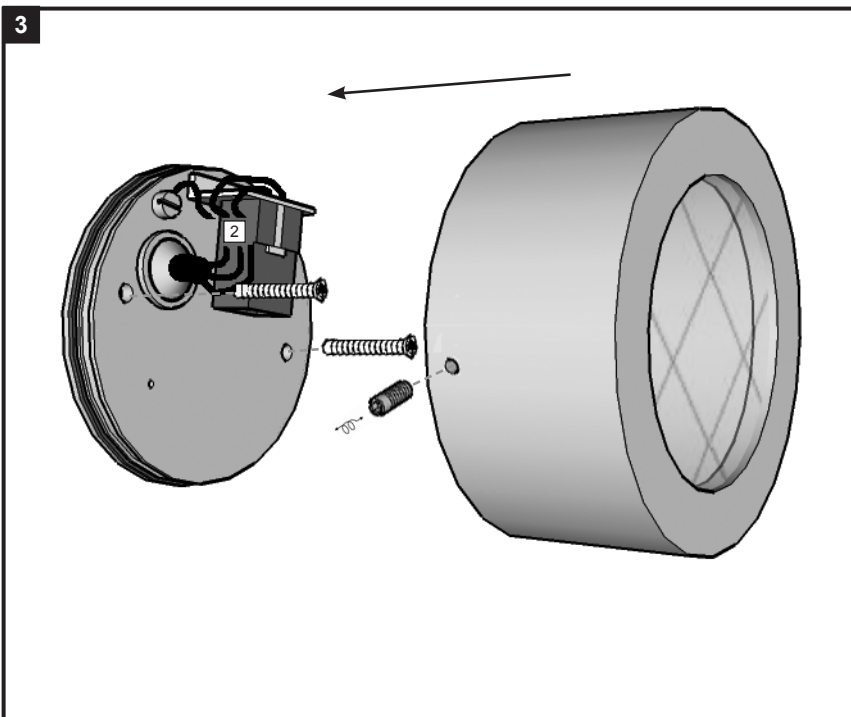
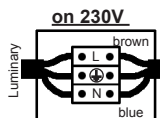

### Warning

**6W - 230V AC**  
1 x Power led incorporated

### ACCESSORY SET (B)

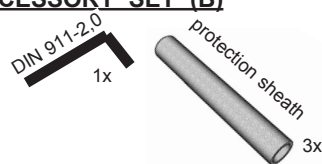

### belpasta 1g

NL Voor een correcte installatie is het verplicht de schroeven te behandelen met belpasta.

FR Pour une bonne installation, vous devez enduire les parties à visser avec la graisse belpasta ci-jointe.

EN For a good installation, it is obliged to put the grease belpasta on the screwing part .

DE Sie müssen die Teile der Leuchte, die geschraubt werden mit dem beigefügten Fett belpasta bestreichen.

GR Για καλυ εγκατασταση, σας συνιστομε να βαλετε στα σημεια προς βιδωμα λιγο γρασο belpasta, το οποιο βρισκεται στην συσκευασια.

## PART

# A

Lees de algemene gebruiksvoorwaarden : PART B  
Lire attentivement les conditions générales d'utilisation : PART B  
Read attentively the general instructions: PART B  
Lesen Sie die allgemeinen Gebrauchsanweisungen: PART B  
Διαβάσατε της γενικες οδηγιες : PART B

WAARSCHUWING  
AVERTISSEMENT  
WARNING  
WARNING  
ΠΡΟΣΟΧΗ